

General Installation Instructions - Surface Mounted Profiles and LED

Important Notes:

All LED runs shall not exceed either 16.4' or 86w (90% of driver output). Runs over 16.4' will have voltage drop and warranty will be void.

Convey typical Tape Light Reels for field installation will have power leads on both ends. It is suggested whenever possible to use the factory power feeds. Only one power lead should be used. Clip on power feeds provided for most L2 products when ordered.

Convey remote 24v DC power supplies must be used and installing electrician shall be aware of Class2 wiring codes and calculating voltage drop (not to exceed 3% from the driver to the strips)

STEP 1

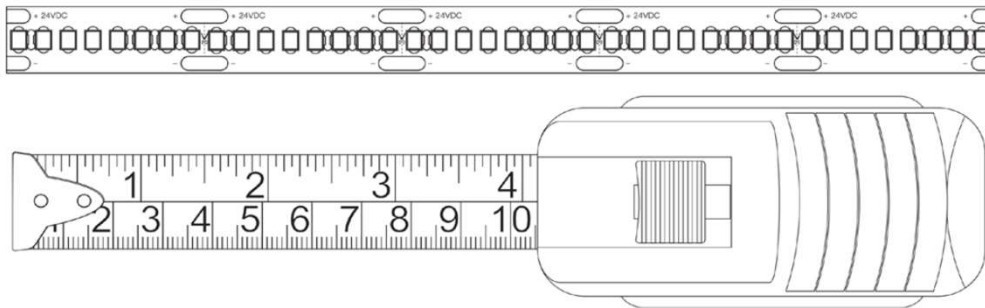

Measure the installation area noting where the LED strips can be cut.

STEP 2

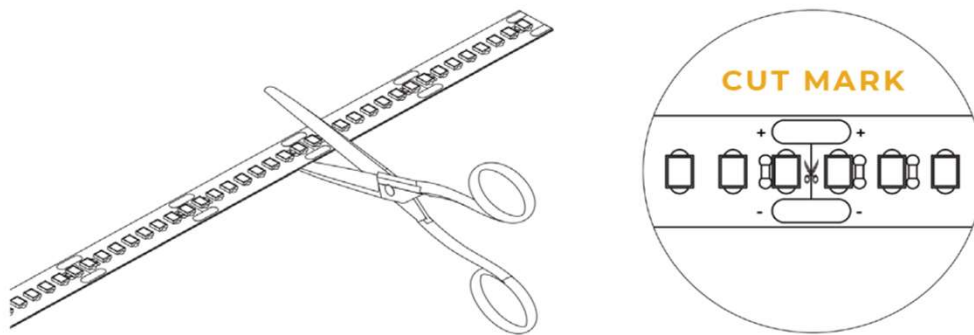

Carefully cut the LED strips to length using sharp scissors. Do not use plyers or electrical strippers to cut the LED Strip!

General Installation Instructions - Surface Mounted Profiles and LED

STEP 3

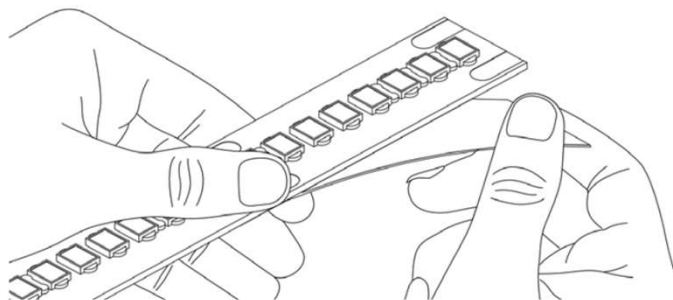

Peel back the 3M backing from the LED strip for the beginning 1" of tape. Do not remove anymore than 1" at this time.

STEP 4

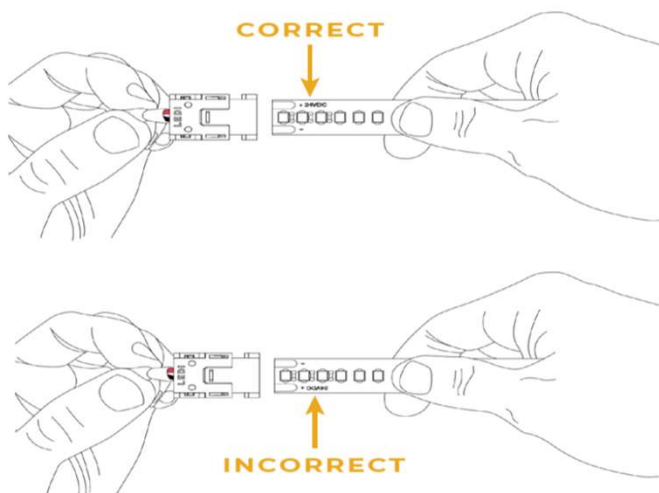

If using clip on feed connectors - insert tape into the feed and aligning the RED (positive) wire with the positive mark on the LED strip. If the polarity is not correct the strip will not illuminate. Never connect LED strips with an energizer driver.

General Installation Instructions - Surface Mounted Profiles and LED

STEP 5

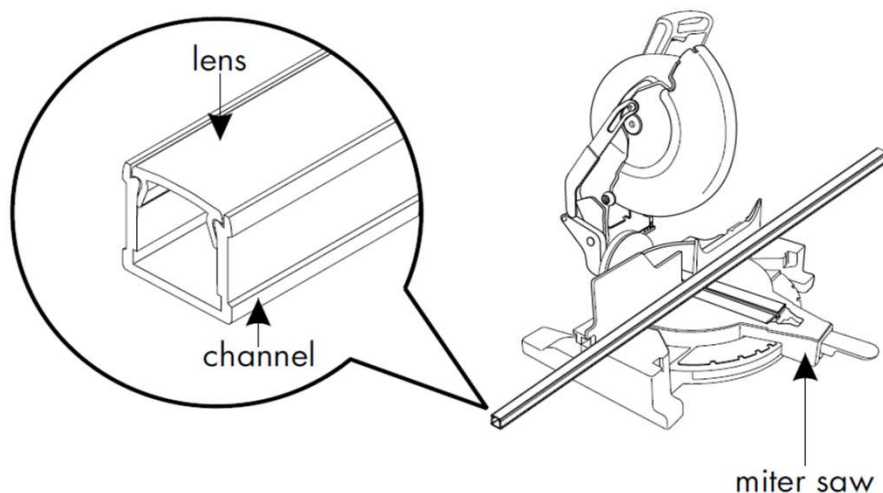

Cut profile and lens to length using a saw equipped with a fine tooth blade specifically for aluminum materials.

The lens should be installed on the aluminum profile when cutting to ensure a clean cut. Cutting the lens without the aluminum will cause chipping.

Installing contractor shall be aware of any saw instructions and limitations and comply with any safety instructions.

Remove the lens and completely clean the inside of the aluminum profile to ensure good contact of the LED in the next step.

STEP 6

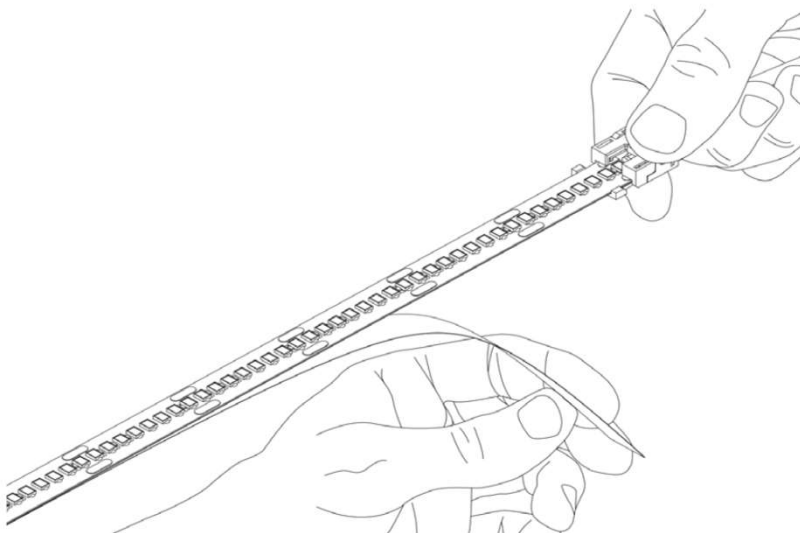

Peel back the 3M backing from the LED strip and install inside the aluminum profile

It is recommended that the backing be slowly removed as the LED is installed in the channel. Do not remove all the backing and then try to install inside the channel - it will be very difficult.

Install end caps and lens

General Installation Instructions - Surface Mounted Profiles and LED

Most of Convey's surface mounted profiles (BE1, BE2-1, BE2-2, BE2-6, BE2-7) are installed using clips that are secured and the aluminum snaps into.

Specific instructions for BE2-3S:



Step 1: install the base



Step 2: install the profile



Step 3: stick led strip



Step 4: install the diffuser



Step 5: fix the endcap



Step 6: done